

Directions from El Paso, TX to Unnamed Rd

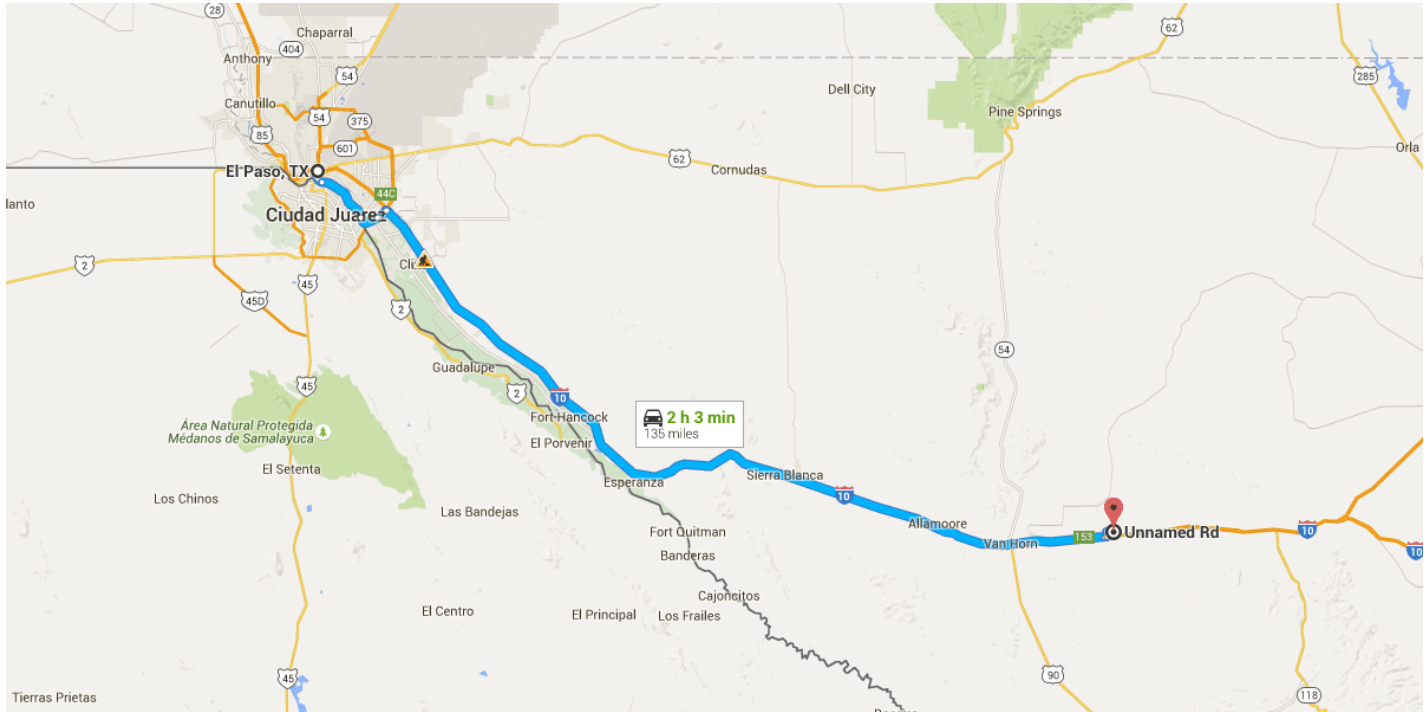

○ El Paso, TX

Take I-10 E to Evergreen Rd in Culberson County. Take exit 153 from I-10 E

133 mi / 1 h 53 min

- ↑ 1. Head southwest on US-54 W
 _____ 0.7 mi
- ↘ 2. Use the left lane to take the Texas Loop 375 E exit
 _____ 0.5 mi
- ↑ 3. Use the left lane to merge onto TX-375 Loop E
 _____ 0.7 mi
- ↘ 4. Keep left at the fork to continue on Loop 375 Express
 ⚠ Toll road
 ⓘ Passing through Chihuahua
 ⓘ Entering Texas
 _____ 7.7 mi
- ↑ 5. Merge onto TX-375 Loop E
 _____ 2.9 mi

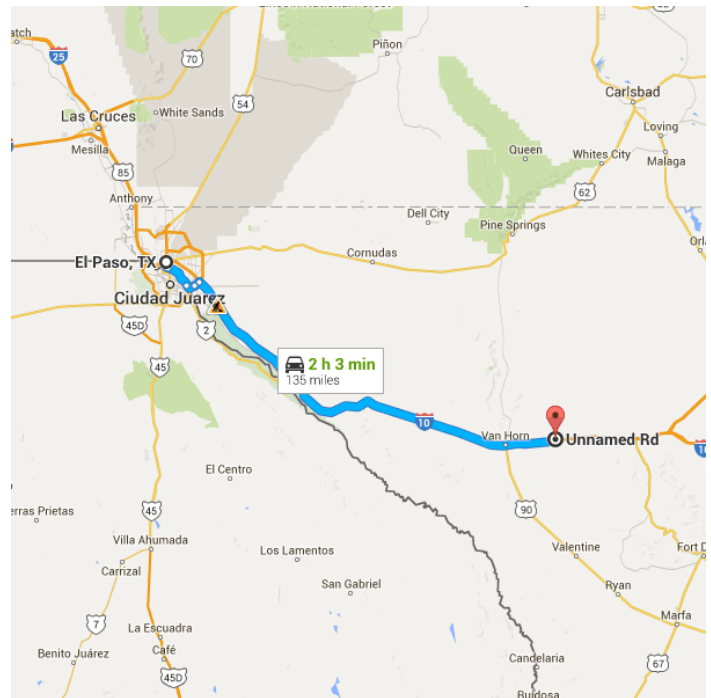

- ↗
 6. Take the exit toward **TX-76/N Loop Rd**

0.2 mi
- ↑
 7. Merge onto **N Americas Ave**

1.3 mi
- ↗
 8. Take exit **44C** toward **I-10 E/Van Horn/San Antonio**

0.2 mi
- ↑
 9. Merge onto **Gateway Blvd E**

0.2 mi
- ↑
 10. Slight **left** to merge onto **I-10 E**

119 mi
- ↗
 11. Take exit **153** toward **Michigan Flat**

0.4 mi

Drive to **John Conoly Rd**

1.7 mi / 8 min

- ↶
 12. Turn **left** onto **Evergreen Rd**

430 ft
- ↑
 13. Continue straight
⚠ Partial restricted usage road

0.2 mi
- ↑
 14. Continue onto **John Conoly Rd**
⚠ Restricted usage road

0.4 mi
- ↘
 15. Turn **right** to stay on **John Conoly Rd**
i Destination will be on the left

1.0 mi

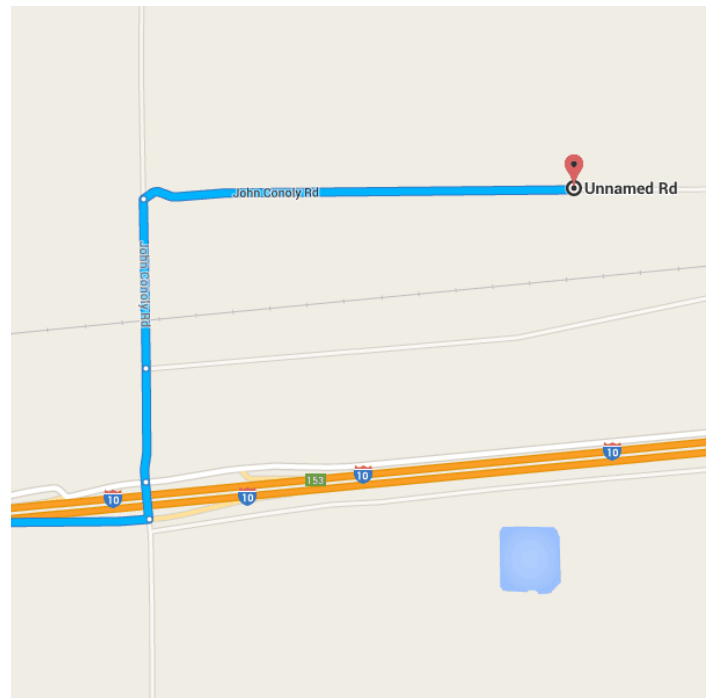

📍 **Unnamed Rd**

Texas

These directions are for planning purposes only. You may find that construction projects, traffic, weather, or other events may cause conditions to differ from the map results, and you should plan your route accordingly. You must obey all signs or notices regarding your route.

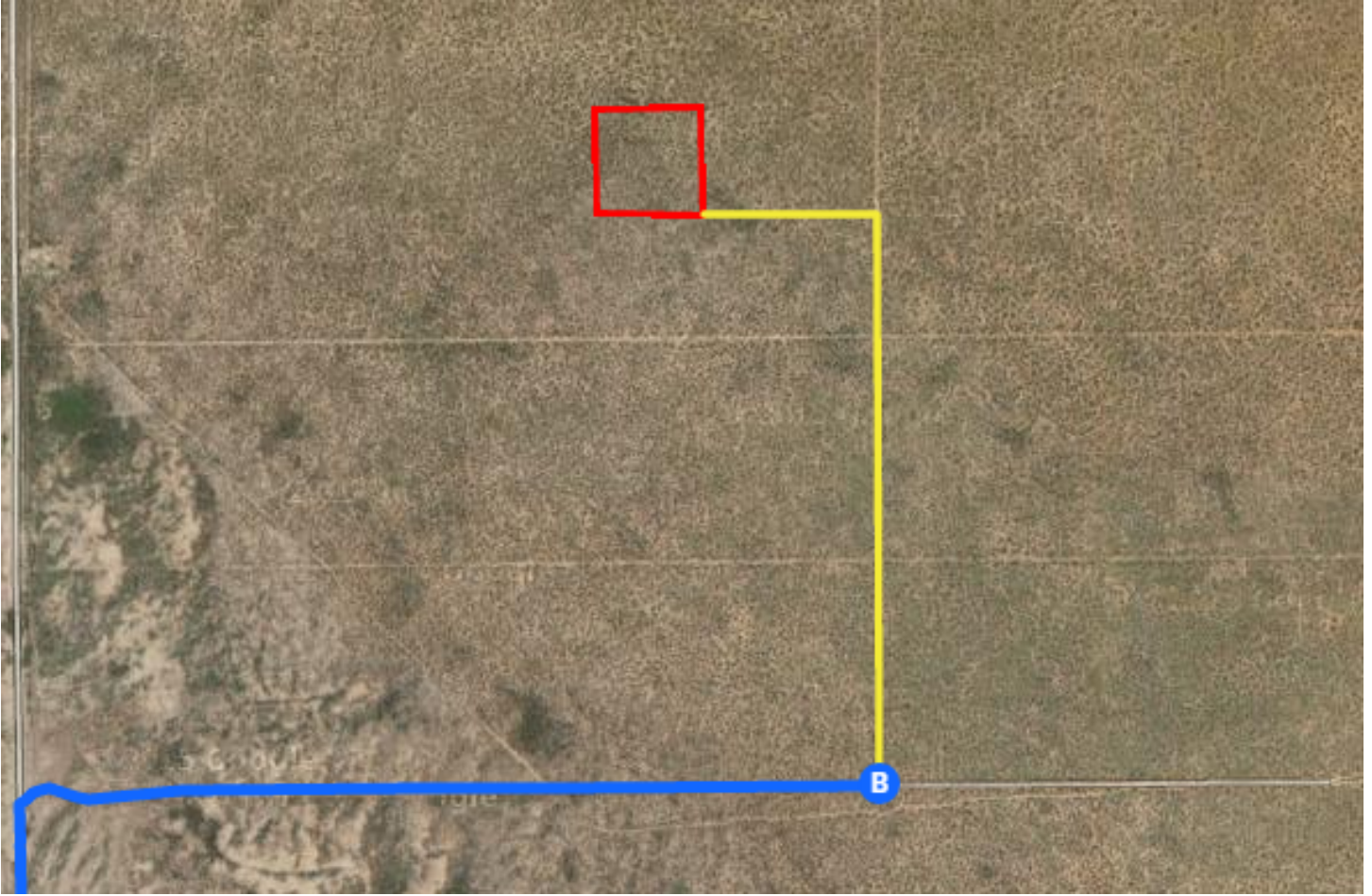

Continued Directions

At the end of the Google earth directions turn left along the dirt road and continue for 0.63 of a mile. Turn left off road and continue directly east for 1000 feet to the SE corner of the property.